

K-LOK 400A Single Pole Connector

Kupo manufactures the highest quality single pole connectors available. Kupo cam-type connector has a superior non-conductive retaining screw that passed through the entire contact for superior durability. These single pole connectors have been designed with ease of assembly and disassembly in mind, no special tools are required. K-LOK series connectors mate with compatible CAM products.

Technical Information

Voltage Rating	600V Maximum	Contact Material	Brass
Amperage Rating	400A Maximum	Terminal Accommodation	#6, #4, #2, 2/0, 4/0 (Longer set screw required for #6 & #4)
Base Compound	Santoprene 105 °C rated	Retaining Pin Material	POM



YOUTUBE
K-LOK 400A SINGLE POLE CONNECTOR



Wide range cable access form 0.33" to 1"



Double set screw terminations



To fit smaller sizes of cable, the brass contact can be made with two smaller dimensions of cable-accessing hole upon request as following :

1. Dia. 16.90 mm (Large hole; standard K-LOK)
2. Dia. 14.60 mm (Medium hole; upon request)
3. Dia. 10.40 mm (Small hole; upon request)



KL-400-BS Retaining Pin
Retaining pin for 400A K-LOK

Line Male

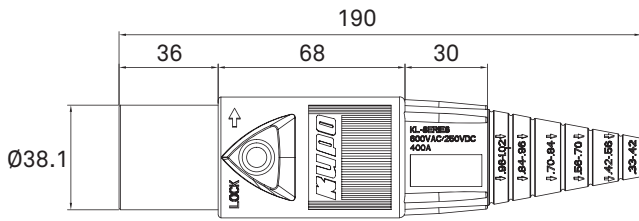

Line Female

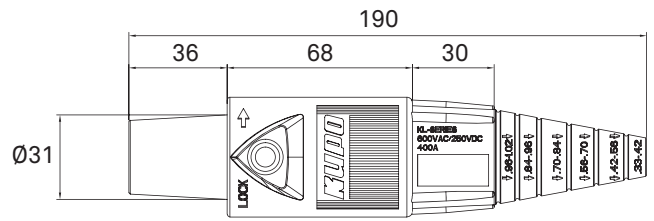

Panel Male

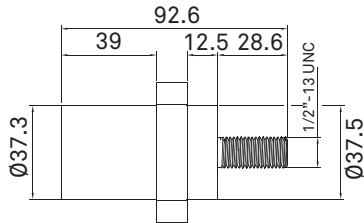

Panel Female

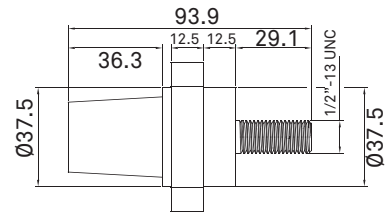

Receptacle Male

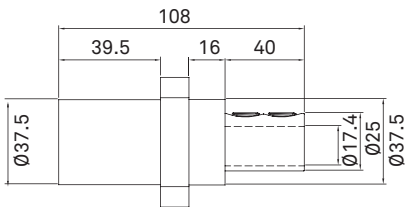

Receptacle Female

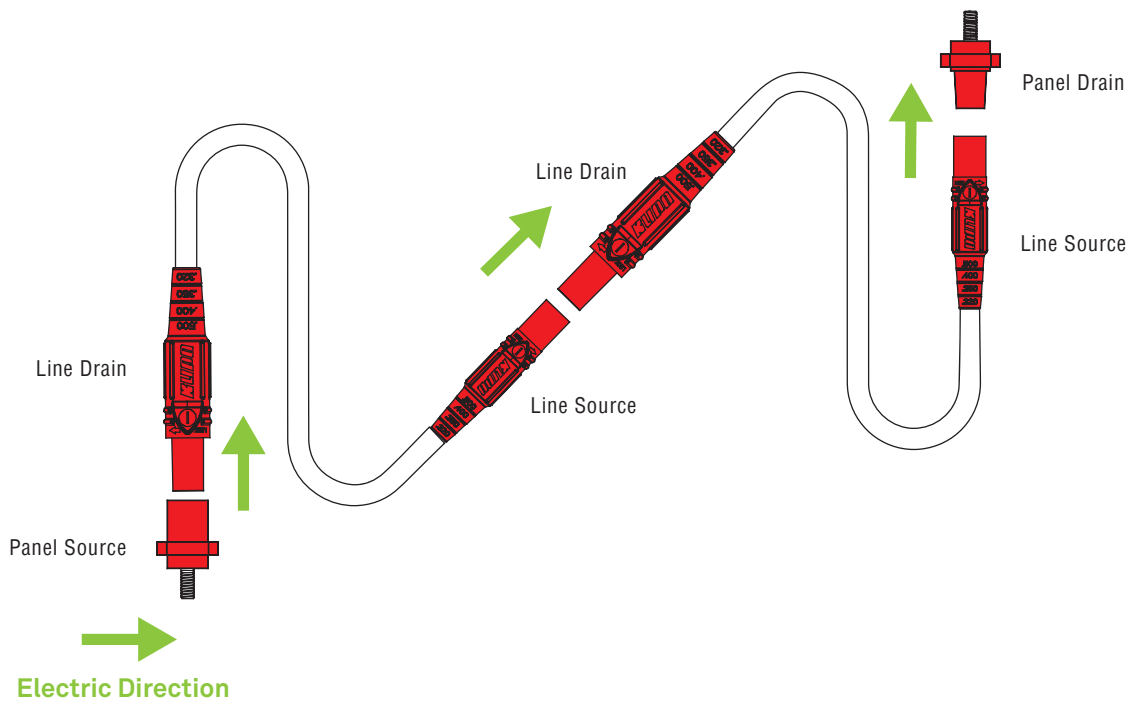
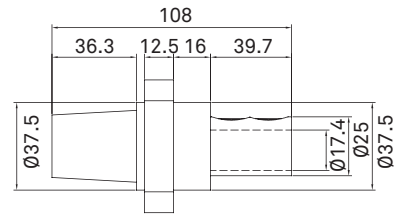

BN
GY
Y
O
KL-400LM
BK
R
B
W
G
 K-LOK 400A In-Line Male Type



BN
GY
Y
O
KL-400LF
BK
R
B
W
G
 K-LOK 400A In-Line Female Type

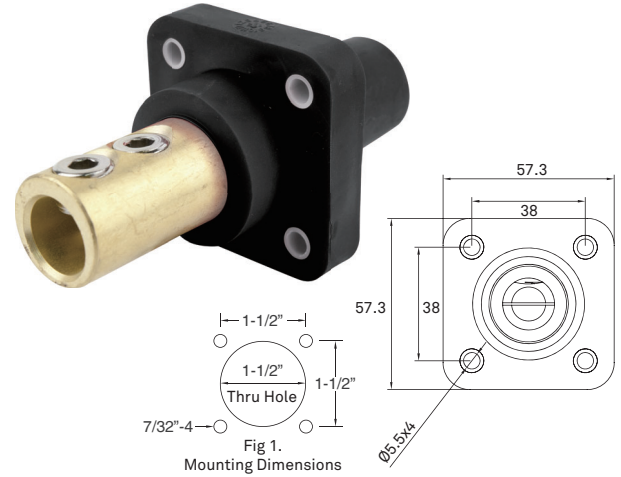
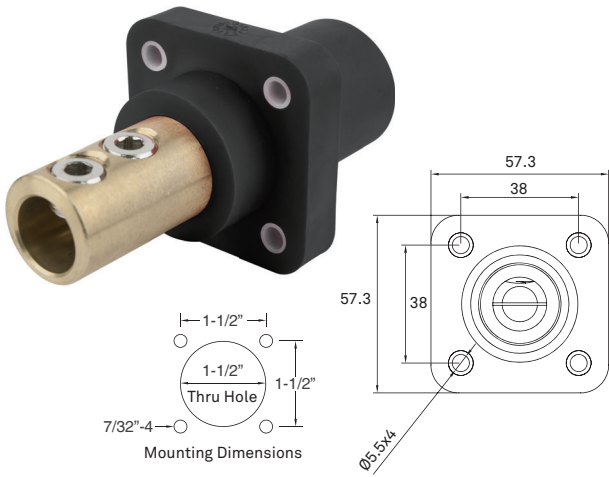

BN GY Y O
KL-400SSM BK R B W G
 K-LOK 400A Receptacle Male
 (Double Set Screw Type)

BN GY Y O
KL-400SSF BK R B W G
 K-LOK 400A Receptacle Female
 (Double Set Screw Type)

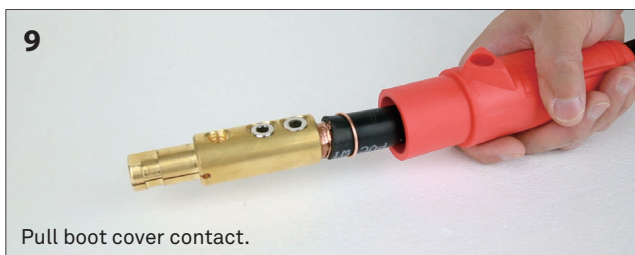
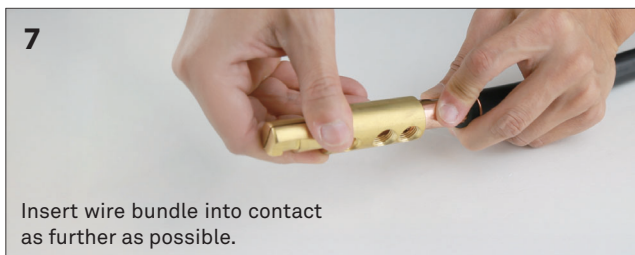
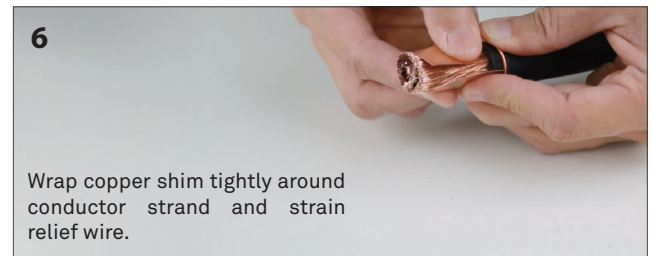
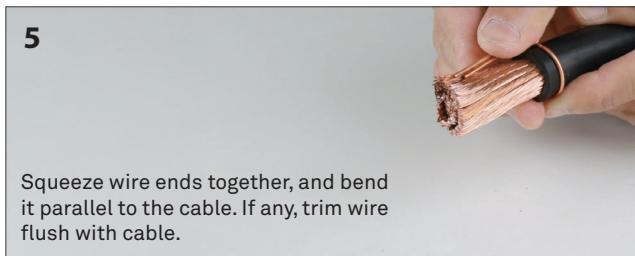
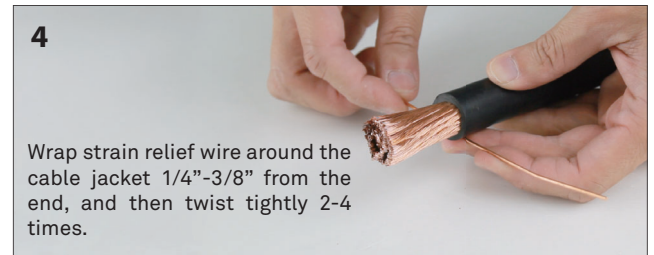
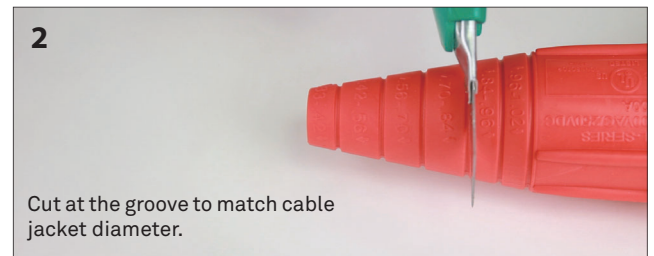
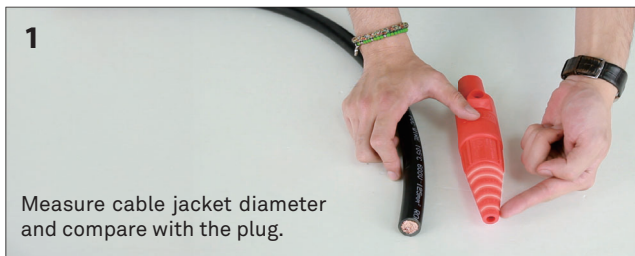

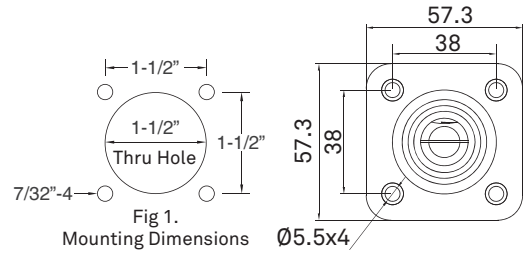
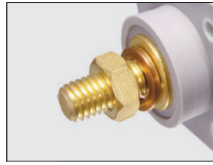

KL-400SM **BK** **R** **B** **W** **G** **BN** **GY** **Y** **O**
 K-LOK 400A Panel Male (Thread-Stud Type)

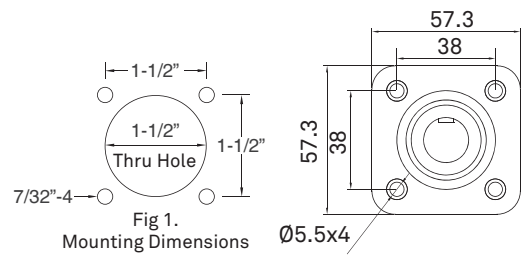
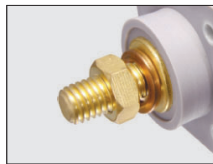

KL-400SF **BK** **R** **B** **W** **G** **BN** **GY** **Y** **O**
 K-LOK 400A Panel Female (Thread-Stud Type)

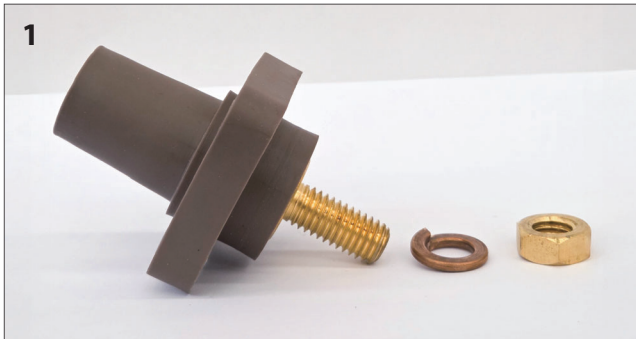

1 Remove the M12 nut and washer from the threaded post.



2 Screw the connector on the panel



3 Fit the terminal over the threaded post



4 Refit the washer and nut onto the threaded post, then tightn to max. of 12N/m

400A Single Pole Distribution Box

Power distribution box for 400A single pole connector. Equipped with sturdy PA plastic box, this distro block is durable with most portability. It comes with 1-Male 400A and 6-Female 400A panel mount connector. Dust cover is outfitted on all inlet and outlet offering greatest protection. Available with 7 colors of 400A connectors.



PDB-P16400BK



PDB-P16400R



PDB-P16400B



PDB-P16400W

400A Single Pole Tapping T Connector

Inline adaptor in form of Male -Female-Female. Consist of Santoprene insulation sleeve and brass contact. Rated for max. 400Amp / 600Volts. Compatible with major brands of cam type connectors. Available with blue, red, black, white and green.



KL-400MFFBK



KL-400MFFR



KL-400MFFB



KL-400MFFW



KL-400MFFG

400A Single Pole Molded Three-Fer

Inline adaptor in form of Male-Female-Female-Female. Three female output connectors molded with 3 feet 4/O cable to one male input connector. Rated for max. 400Amp / 600Volts. Compatible with major brands of cam type connectors. Available with blue, red, black, white and green.



KL-400MM3FBK



KL-400MM3FR



KL-400MM3FB



KL-400MM3FW



KL-400MM3FG



KL-400M3FBK



KL-400M3FR



KL-400M3FB



KL-400M3FW



KL-400M3FG

Made of rubber cubic box featuring sturdy and robust housing. This range of distro boxes are fabricated with cUL-listed 400A K-LOK and 150A K-LOK receptacles, as well as CE-approval 400A PowerFit receptacles. The boxes are made as Three-Fer, one power input and three outlets, for the greatest electric utility. Boxes with K-LOK connectors comes with color-coded duct cover to get the protection again moisture and dust. Available in full electrical color code range in USA and Europe. Fully insulated, flame-retarded and UV resistant.

400A K-LOK Rubber Cubic Power Distro Box



PDB-C1301BK



PDB-C1301R



PDB-C1301B



PDB-C1301W



PDB-C1301G

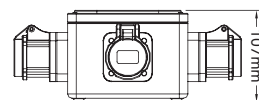
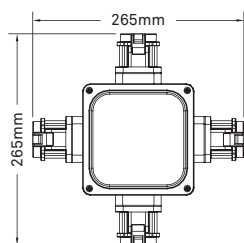

K-LOK 150A Single Pole Connector (Mini-Cam)

Mini-Cam is a series of 150 Amp light duty single pole connector in addition to heavy duty 400 Amp ones. Like its heavy duty family members, Mini-Cam is also constructed of Santoprene, possessing a superior performance in insulation. With enhanced features on safety designs and wider range of cable accommodation, Mini-Cam is the ideal and reliable connector for your own job.

Technical Information

Voltage Rating	600V Maximum	Contact Material	Brass
Amperage Rating	150A Maximum	Terminal Accommodation	#8, #6, #4, #2
Base Compound	Santoprene 105 °C rated	Retaining Pin Material	POM

Features

- Cable accommodation from #8 AWG to #2 AWG (for cable outside diameter up to 13.60 mm).
- POM (Polyformaldehyde) ring is two times longer than others for fully encompassing the brass contact for excellent insulation.
- Housing with large ribs for comfort gripping; prolonged body helps user to hold it firmly.
- Two additional longer set screws are supplied for maximum flexibility when smaller cable is used.
- Compatible with other brands of 150A cam-type connector.
- UL/CUL Certified



Double set screws ensure the cable sits firmly in position; longer set screws are supplied for securing smaller cables.



Boot made of UV-resistant Santoprene, providing excellent protection. Safer and more durable.



Cable size or cut-length identification clearly engraved on the boot.



The tension hole at rear side of split contact retains the contact from over pressed, so as to prevent the loose mating after several time of uses.



KL-150-BS Retaining Pin
Retaining pin for 150A K-LOK

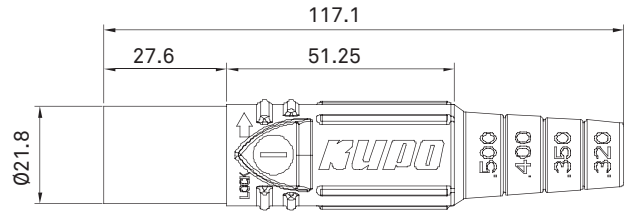

KL-150LM **BK** **R** **B** **W** **G** **BN** **GY**
K-LOK 150A In-Line Male Type

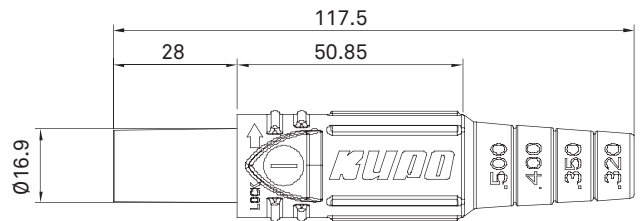

KL-150LF **BK** **R** **B** **W** **G** **BN** **GY**
K-LOK 150A In-Line Female Type

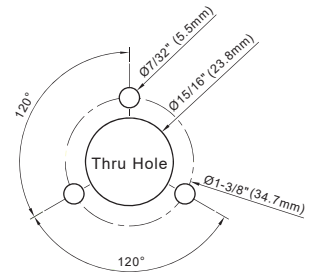
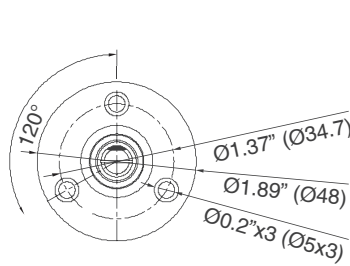

Mounting Dimensions

KL-150SM **BK** **R** **B** **W** **G** **BN** **GY**
K-LOK 150A Panel Male (Thread-Stud Type)

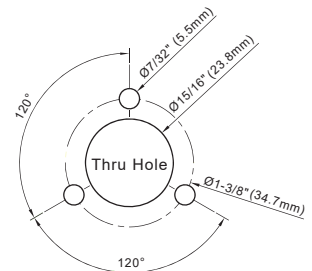
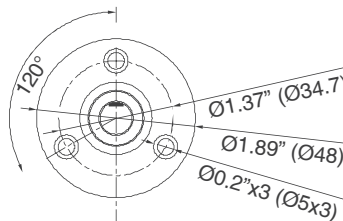

Mounting Dimensions

KL-150SF **BK** **R** **B** **W** **G** **BN** **GY**
K-LOK 150A Panel Female (Thread-Stud Type)

K-LOK Protective Cap

Available in both inline male and female variants, K-LOK Protective Cap is designed to seamlessly complement your cam-type connectors, ensuring a secure fit to meet NEMA 3R rating and safeguarding against dust, debris, and environmental elements. Crafted from high-quality Santoprene, the same durable material utilized in 400A & 150A connectors, this product guarantees exceptional reliability and longevity. Each cap comes equipped with a convenient lanyard for effortless attachment. Offered in a variety of colors to match the aesthetics of inline connector.

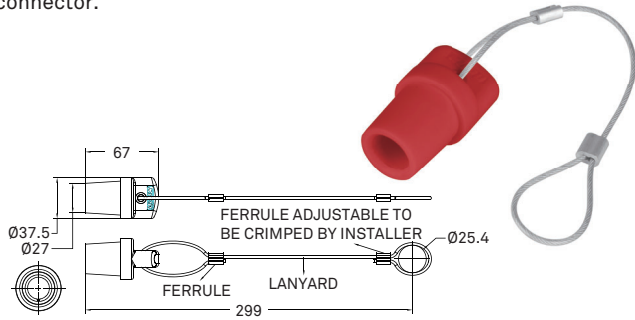

BN GY Y O

KL-40MPC BK R B W G
For 400A inline male connector

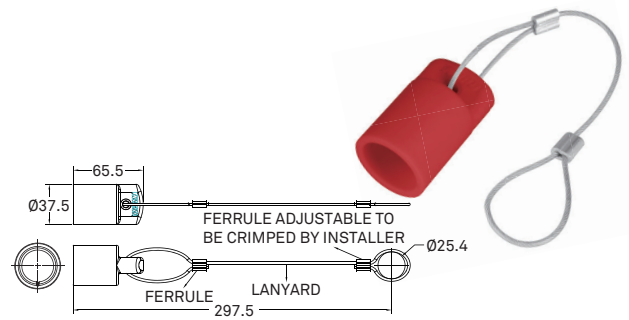

BN GY Y O

KL-40FPC BK R B W G
For 400A inline female connector

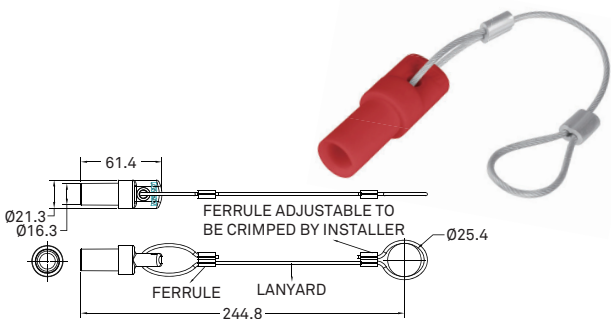

KL-15MPC BK R B W G BN GY
For 150A inline male connector

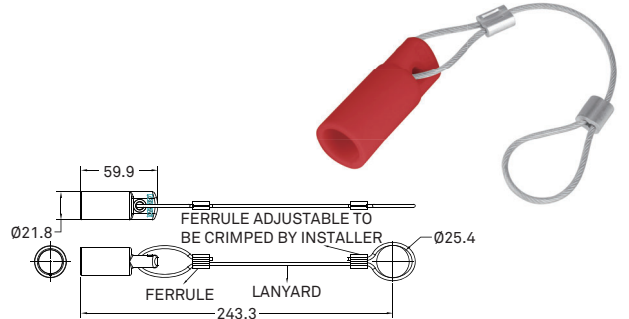

KL-15FPC BK R B W G BN GY
For 150A inline female connector

K-LOK Weatherproof Snap Back Cover

Weatherproof snap back protective cover to fit all compatible brands of 400A cam type receptacles. Standard frame dimension allows retrofit existing application easily. The gasket offers a NEMA 3R rated environmental seal that provides a protection against falling rain, dust or frost, and also provides a safe way to cover exposed metal, while keeping the weather out when the receptacle is not used. Kupo Dust Cover is made from a high impact resistant, flame retardant ABS material and corrosion resistant stainless steel hardware. Five colors available for phase identification.

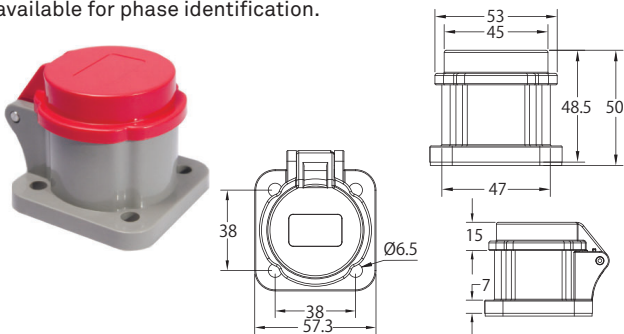

KL-DC BK R B W G BN GY Y O
For 400A Cam-Type Receptacle



KL-DCT
K-LOK Clear Dust Cover For 400A Cam-Type Receptacle

Clear Dust Cover (KL-DCT) is made of polycarbonate, a tough and durable plastic. It is totally transparent and features see-through visual identification. Assembled with stainless steel hardware but no gasket is supplied.

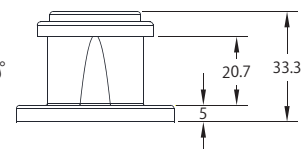
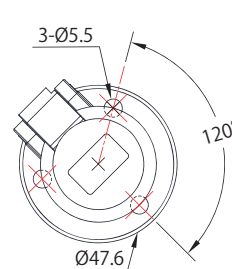
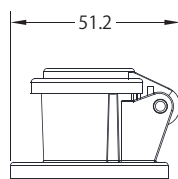

KL-DC BK R B W G BN GY Y O 2
For 150A Cam-Type Receptacle