

Stage Pin Connector (20 AMP Inline plugs and connectors)

This 20A connector is engineered for reliability, ease of use, and long-term performance across a variety of demanding applications. Fully compatible with all other standard 20A connectors, it features a high-temperature thermoplastic body rated up to 250°C, ensuring exceptional durability without melting or breakdown.

The ergonomic housing provides a comfortable grip for frequent handling, while the crimpless pressure terminal eliminates the need for ring terminals, paired with a wider wiring chamber, it allows for easier, faster wiring. Inside, the brass pins are fully removable and float within the housing for precise alignment and minimal resistance, and can be replaced if damaged.

The female sleeves are spring-loaded with a split design that maintains constant pressure on the male pin, ensuring consistent contact even with slightly deformed or crushed pins. Terminals are clearly marked according to NEC standards to prevent mis-wiring, and the rear cable entry is designed to accept standard 12/3 hard-service cables.

This connector offers a perfect balance of rugged performance, smart design, and installation efficiency, making it a trusted solution for professionals in the field.

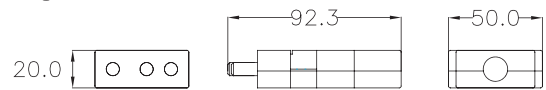
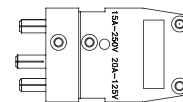
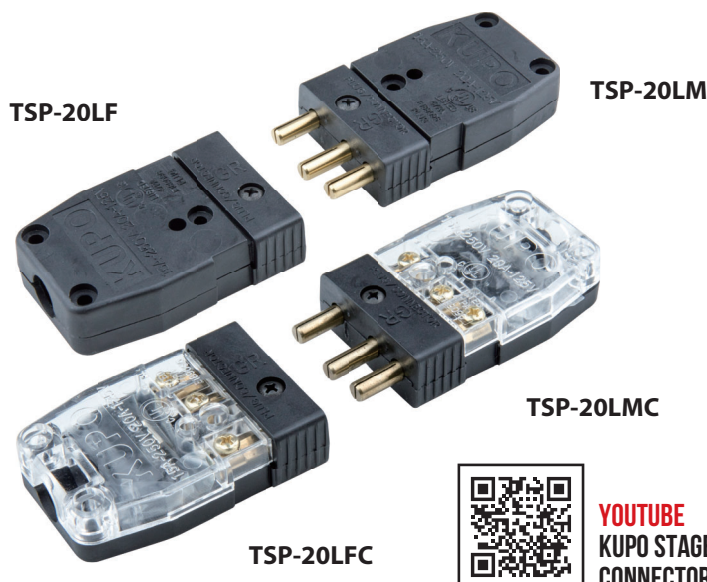

TSP-20LM MALE INLINE

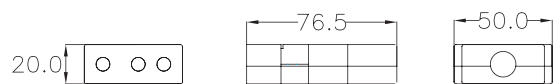
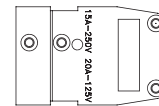

TSP-20LF FEMALE INLINE

YOUTUBE
KUPO STAGE PIN
CONNECTORS



TSP-20SF

TSP-20SM

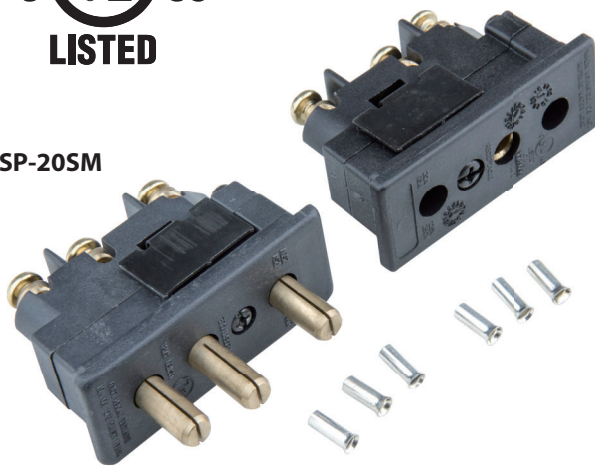

20 AMP Panel Mount Stage Pin Connector

Purpose-built for the demands of live events and touring environments, these panel-mount connectors are ideal for power distribution in stage, lighting, and AV applications. Available in both male and female versions, each connector features a screw-driven mounting clip for fast, tool-friendly installation on panels of varying thickness, perfect for quick setups and breakdowns on the road.

Precision-machined solid brass contacts ensure reliable power delivery under heavy use. Stripped conductors can be inserted through the cross-hole and pressure-terminated using the included wire shoes, while panel-mounted models also support ring terminations for added flexibility in different rigging configurations.

A self-grounding mounting clip streamlines setup by removing the need for a separate ground wire, helping crews work faster and safer. Designed to precisely match industry-standard panel cutouts, these connectors offer a dependable fit for custom panels and touring racks, making them a go-to choice for professionals in the field.

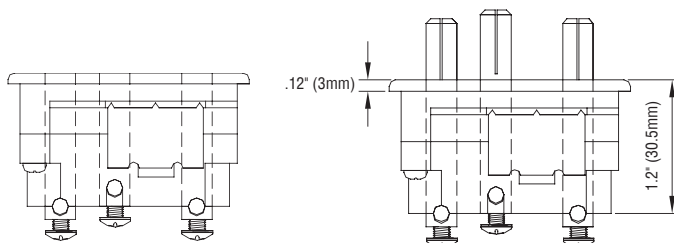

FEMALE PANEL MOUNT

MALE PANEL MOUNT

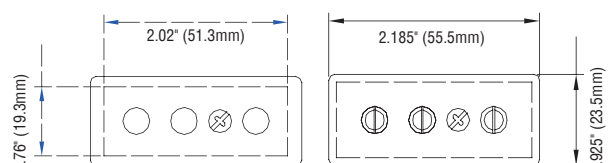

Panel Cutout 0.760 x 2.020 (inch)
16 Gauge, 0.06" Material



YOUTUBE
KUPO STAGE PIN
TESTERS FT. VOLTAGE
METER & LAMP TESTER



TSP-20LMTR Stage Pin Power Tester

A simple and compact voltage meter to use with stage pin. No cumbersome setting and switching. Works on 90-240VAC wide range of voltage. Also the LED will light up while the tester detect the wiring of Live and Neutral is switched. Supplied with lanyard and hook for easy belt attachment to carry on.

TSP-20LFTR Kupo Stage Pin Lamp Tester

Kupo Stage Pin lamp tester helps to diagnose the bulb continuity before you rig the fixture. While LED indicator fails to response, please check the lamp (bulb) to make sure it is not burned out. If the bulb is good, then there is something wrong with wiring. It has a built-in battery so external power is not required. Plus, it comes with a buzzer and you will not only see but hear authentically the test result.

Features

- Quickly test for lamp (bulb) continuity or short by plugging into tester.
- Easily to indicate a good lamp while tester is buzzing and green LED lights up.
- Come with a key ring for clipping the tester to tool belt.
- Built-in CR2032 Lithium DC3V battery.

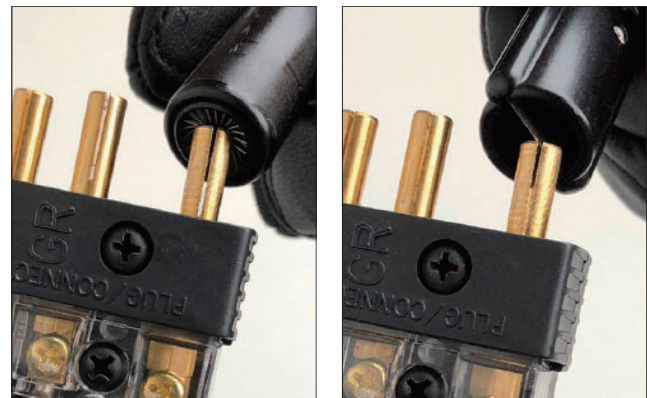

TSP-PS Pin Splitter For Stage Pin

Used for clean, straighten, and spread the stage pins. Made of insulative polycarbonate material, it is strong and durable. A built-in wire brush helps to clean the pins of 20A stage pin connectors, and a recessed blade spreads the compressed pins to make a good electrical contact. Comes with a Nylon belt pouch with hook and loop flap closure.

KUPO Dr.Harting & Dr.Soca

Dr. Harting and Dr. Soca are dual-function testers designed for diagnosing wiring on 19-pin Soca or Multipole (Letriflex/Harting) extension cables, as well as checking lamp/load status on lighting bars.

The LCD displays real-time test results through pin-to-pin scanning. Any wiring issue such as missing connections, swapped pins, shorts, or opens, is clearly shown on the screen. Operating instructions are laser-engraved on the main chassis for fast and intuitive use.

Press the "RUN" button to initiate testing and navigate operational modes. The auto-sense feature automatically switches between cable-testing and load-testing modes. The unit is powered by 4 x AAA batteries or an external 5-18 V adaptor, and it automatically powers off after 100 seconds of inactivity to conserve energy.

Threadless 19-pin connectors and open Multipole interfaces allow convenient access when working with extension cables. Both testers feature a lightweight, compact aluminum-alloy chassis and can be bolted to a work bench, providing a stable platform for cable-assembly work.



DR-H16 Dr. Harting

Tester for Multipole (Letriflex) 16-pin connectors.



DR-S19 Dr. Soca

Tester for Soca 19-pin connectors.

Threadless 19-Pin connector provides a swift and convenient plug-and-play.



YOUTUBE
DR.SOCA
19PIN TESTER



Cable Testing Mode



Real-Time Cable Test Result

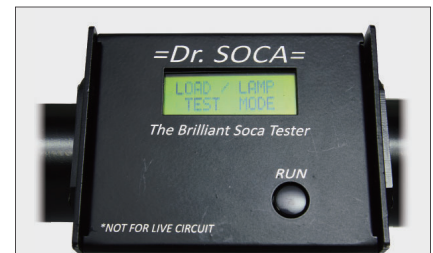

Lamp / Load Testing Mode

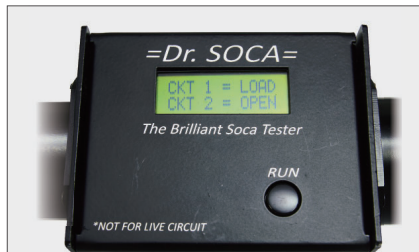

Real-Time Load Test Result



DR.Soca can be used either with DC/5-18V Adaptor.



DR.Soca can be used either with 4 x AA Battery.



Roomy slot for hand-carry.



Other than cable tester, it also conduct lamp/load testing.



Bolted to a work bench without movement for better cable testing job.

KUPO 19-pin Cable Tester

The KUPO 19-pin Cable Tester is a compact and efficient tool designed for fast and reliable testing of 19-pin Soca extension cables. Built with a classic PLS-series connector, it is fully compatible with cable sets using major brands of Socapex-style connectors.

Simply connect the cable, and the tester automatically evaluates the circuit status. A rotary channel selector with six LEDs on the female connector allows users to check each channel individually. A red LED clearly indicates any wiring faults such as miswiring or open circuits.



YOUTUBE
KUPO 19-PIN
CABLE TESTER

Threadless 19-Pin connector provides a swift and convenient plug-and-play.



PLS-5219IDTR-M

ID Cable Tester, Male

PLS-5219IDTR-F

ID Cable Tester, Female

PLS-5219IDTR-PAIR

Complete set (Male + Female)



Designed for portable field use.



The tester features bright LEDs with reduced power consumption.



A buzzer provides audible warning if a short circuit is detected between the ground and live conductors.

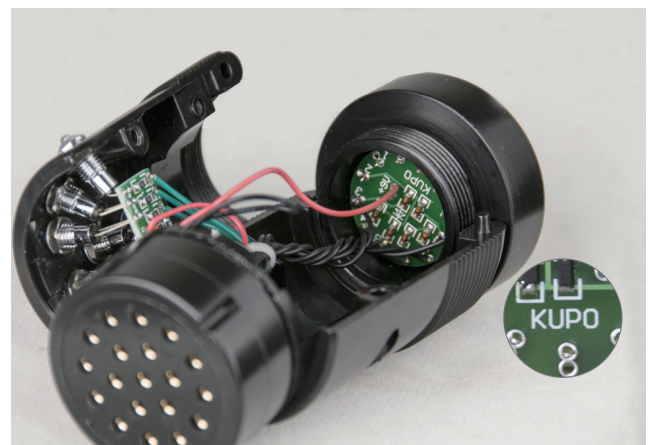

All electronic components are PCB-mounted and securely interconnected for durability.

KUPO Digi-Check — Multi-Function DMX Diagnostic Tool

The KUPO DIGI-CHECK is a compact, multi-function device designed for DMX512 signal diagnostics and cable testing. It integrates a DMX detection module with a bright white LED torch light, making it an essential tool for technicians on the move.

Features

- 9 LEDs provide detailed indication of DMX signal and data-line status.
- Auto power-off after 120 seconds of inactivity to preserve battery life.
- Tool-free battery replacement.
- Supplied with a leather pouch and strap for maximum portability.
- CNC-machined anodized aluminum housing.
- Built-in white LED torch light.
- 3-pin and 5-pin XLR male and female connectors.
- Embedded DMX512 signal-level and load analyzer.
- Supports individual or installed data-line inspection modes.

Specifications

- Power supply: DC 12 V / 1 A
- Battery: LR44 × 3 pcs (included)
- Supports DMX512 / 1990 protocol
- DMX connectors: XLR 5-pin × 2, XLR 3-pin × 2

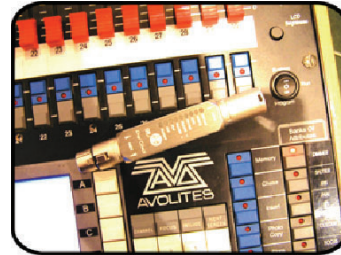

YOUTUBE
KUPO DIGI-CHECK

DC-920 5-Pin Digi-check / Multi-function DMX Tester

Dimension: 22 x 137 mm
Weight: 0.15kg

DC-930 3-Pin Digi-check / Multi-function DMX Tester

Dimension: 22 x 137 mm
Weight: 0.15kg



Innovative Function

For testing pre-installed DMX lines, place one Digi-check at each end of the cable.
(Requires one XLR female adaptor for this operation.)



DS-TM3 DIGI-SIT / DMX Terminator (XLR 3 PIN)

DS-TM4 DIGI-SIT / DMX Terminator (XLR 4 PIN)

DS-TM5 DIGI-SIT / DMX Terminator (XLR 5 PIN)

A DMX terminator is essential for maintaining signal integrity in DMX512 systems.

It reduces signal reflections, stabilizes transmission, and improves overall DMX performance.

KUPO DMX Terminators include integrated protective circuitry and an LED indicator that confirms the presence of DMX data.

Dimension: 100(W) x 133(H) x 50(D) mm / Weight: 0.04kg